

SEAT

Designer: SPARK - Danielle Duvoisin



SLAT OPTIONS

- Oiled hardwood
- Composite
- Clear anodised aluminium
- Wood grain aluminium

FRAME OPTIONS

- Cast aluminium

FRAME FINISHES

- Powdercoated

INSTALLATION

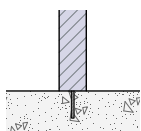

Concealed Fix

FIXINGS

- 12mm threaded rod, supplied for 14mm diameter

Alternative materials and finishes available on request

PRECINCT SEAT

SPECIFICATIONS

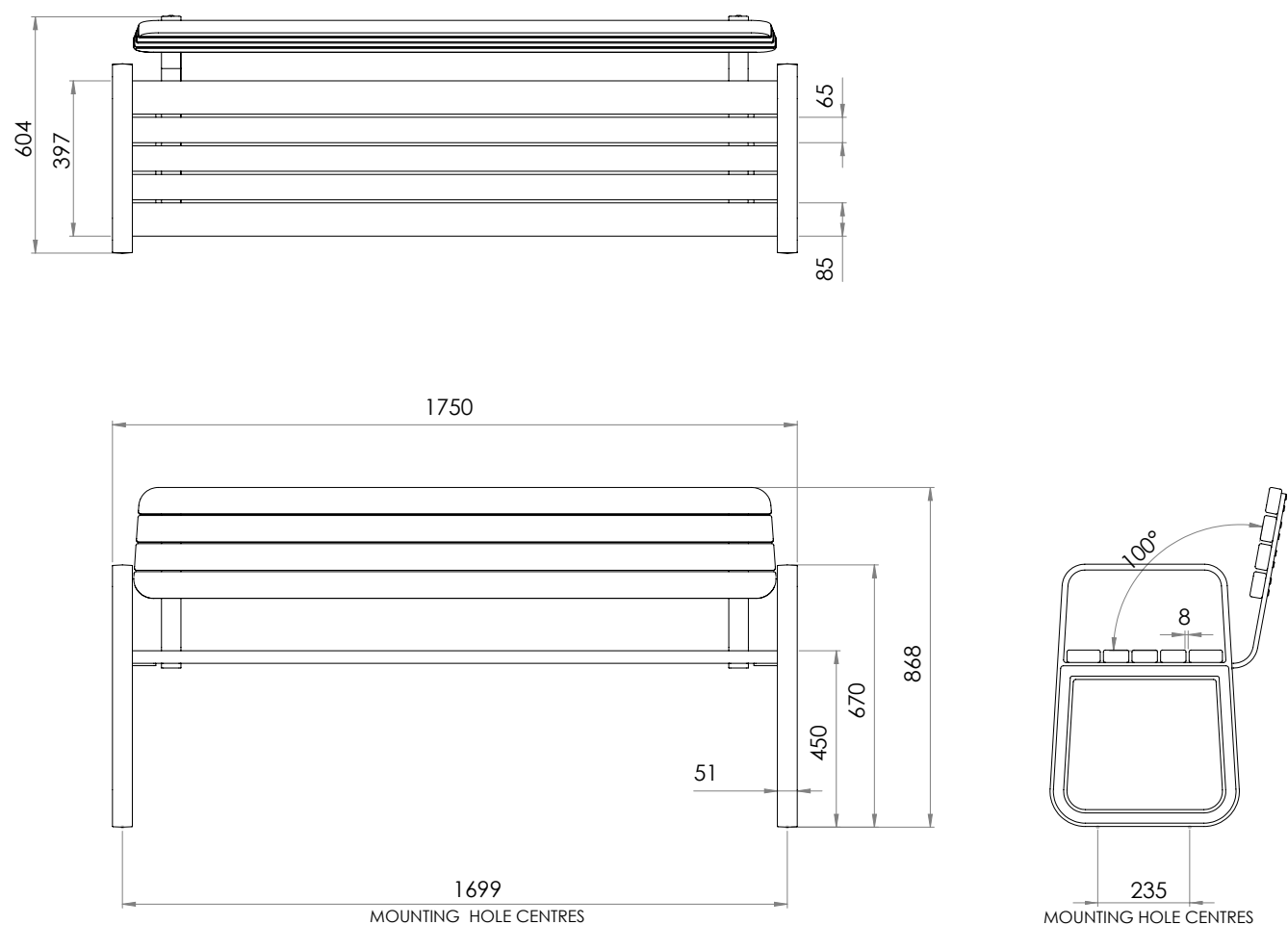

All measurements are in millimetres. Drawings are not to scale.
Dimensions shown are for timber slat option.

PRODUCT CODE	FRAME FINISH	SLAT OPTION & SIZE (mm)
PRC003-ALU-PC-T	Powdercoated	65 & 85x32 Oiled hardwood timber
PRC003-ALU-PC-C	Powdercoated	60x40 Composite
PRC003-ALU-PC-A	Powdercoated	65x35 Clear anodised aluminium
PRC003-ALU-PC-W	Powdercoated	65x35 Wood grain aluminium